

301-864-3828

Standard Hanger Range



Used to suspend a variety of HVAC, mechanical and electrical services from different substrates.

FEATURES / BENEFITS

- Ideal for fast suspension of cable containment, pipework, air conditioning
- Up to six times faster to install than traditional hanging systems
- Versatile and simple to use
- Strong, safe and industry approved
- Aesthetically discreet and lightweight
- Supplied in ready-to-use kits, comprising a length of cable, pre-crimped End Fixing, Gripple Hanger and Setting Key



INSTALLATION & ADJUSTMENT

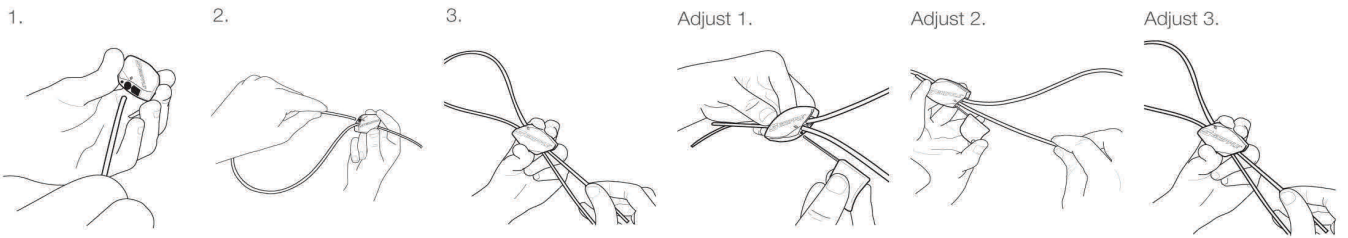

Ensure a minimum 3 inches of tail cable exits the hanger.

SPECIFICATION

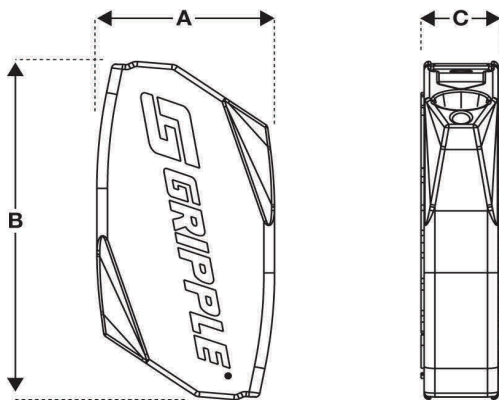

Dimension	No.1 (inches)	No.2 (inches)	No.3 (inches)	No.4 (inches)	No.5 (inches)
A	0.63	0.71	1.02	1.47	1.69
B	0.94	1.34	1.69	2.44	4.17
C	0.24	0.31	0.31	0.43	0.51

AVAILABLE END FIXINGS

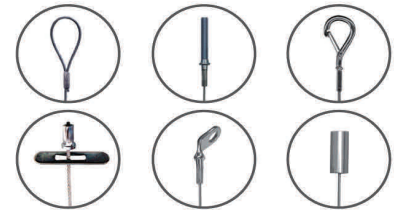

For more options on available end fixings please contact us or visit www.gripple.com

SUBMITTAL INFORMATION

Safe Working Load:

No.1 - 25 lbs No.4 - 500 lbs
No.2 - 100 lbs No.5 - 715 lbs
No.3 - 200 lbs

All with a 5:1 safety factor

Material:

Housing - Type ZA2 Zinc
Wedge - Sintered steel hardened to min. 56 Rockwell C
Spring - Stainless Steel (Type 302)
End Cap - UV stabilized homopolymer propylene





301-864-3828



Ductwork Hanger Data

Rectangular duct (unlined), based on 8' hanging space and two hanger method.

Rect. Duct size (height + width)	Weight / ft.		Weight / 8 ft.	Grippler Hanger Size Needed (2 per 8ft.) *	Safety Factor
	20 Gauge	22 Gauge			
80 x 20"	28.10	--	224.80	3	8:1
70 x 24"	26.44	--	211.52	3	9:1
66 x 24"	25.34	--	202.72	3	9:1
50 x 20"	19.82	--	158.56	2	12:1
40 x 22"	19.27	--	154.16	2	12:1
36 x 18"	--	13.08	104.64	2	9:1
24 x 12"	--	8.86	70.88	2	14:1
16 x 16"	--	7.92	63.36	2	15:1
14 x 10"	--	6.05	48.40	2	20:1
12 x 6"	--	4.64	37.12	2	26:1
10 x 6"	--	4.17	33.36	2	29:1
8 x 6"	--	4.17	33.36	2	29:1

*No.2 Grippler = 100 lbs SWL per hanger, 5:1 safety factor
 No.3 Grippler = 200 lbs SWL per hanger, 5:1 safety factor

Spiral duct, single wall, based on 10' hanging space.

Diameter	Circumference	Grippler Hanger Size		
		26 Gauge	24 Gauge	22 Gauge
12"	3' 2"	2	2	2
16"	4' 2"	2	2	2
20"	5' 3"	2	2	2
24"	6' 3"	2	2	2
28"	7' 4"	2	2	3
32"	8' 5"	2	3	3
36"	9' 5"	2	3	3
40"	10' 6"	3	3	3
44"	11' 6"	3	3	3
48"	12' 7"	3	3	3
52"	13' 7"	3	3	4
56"	14' 8"	3	3	4
60"	15' 8"	3	4	4

Spiral duct, double wall, based on 10' hanging space.

Inside diameter (in)	Outside gauge	Inside gauge	Wt/Ft (lbs)	Grippler size
12"	26	26	8.0	2
16"	24	24	11.0	3
20"	24	24	13.4	3
24"	24	24	18.0	3
28"	22	24	22.3	4
32"	22	24	25.2	4
36"	20	22	31.2	4
40"	20	22	36.7	4
44"	20	22	40.2	4
48"	20	22	43.8	4
52"	18	20	56.2	5
56"	18	20	60.8	5

Please note, calculations do not take into account weight of connectors.

Hanger length charts

Standard hanging (for spiral duct 36" and smaller)

Duct size (diameter)	Dim. A (minimum)	Grippler cable length needed (ft)						
		Elevation from roof to top of duct						
		5'	8'	10'	12'	15'	18'	20'
12"	3"	10'	15'	15'	20'	20'	25'	25'
14"	3.5"	10'	15'	15'	20'	20'	25'	25'
16"	4"	10'	15'	15'	20'	20'	25'	25'
18"	4.5"	10'	15'	15'	20'	20'	25'	25'
20"	5"	15'	15'	20'	20'	25'	25'	30'
22"	5.5"	15'	15'	20'	20'	25'	25'	30'
24"	6"	15'	15'	20'	20'	25'	25'	30'
26"	6.5"	15'	15'	20'	20'	25'	25'	30'
28"	7"	15'	20'	20'	20'	25'	30'	30'
30"	7.5"	15'	20'	20'	20'	25'	30'	30'
32"	8"	15'	20'	20'	25'	25'	30'	30'
34"	8.5"	15'	20'	20'	25'	25'	30'	30'
36"	9"	20'	20'	25'	25'	30'	30'	35'

Cradle hanging (for spiral duct larger than 36")

Duct size (diameter)	Grippler cable length needed (ft)						
	Elevation from roof to top of duct						
	5'	8'	10'	12'	15'	18'	20'
36"	20'	30'	30'	35'	40'	50'	50'
38"	20'	30'	30'	35'	40'	50'	50'
40"	25'	30'	35'	35'	45'	50'	55'
44"	25'	30'	35'	40'	45'	50'	55'
46"	25'	30'	35'	40'	45'	50'	55'
48"	25'	30'	35'	40'	45'	50'	55'
50"	25'	30'	35'	40'	45'	50'	55'
52"	25'	30'	35'	40'	45'	50'	55'
56"	25'	35'	35'	40'	45'	55'	55'
60"	30'	35'	40'	40'	50'	55'	56'

- All hangers are available in 5', 10', 15', 20' and 30' standard lengths
- Lengths rounded up to nearest 5 ft increment
- Size of cable hanger (No.1 - No.5) will be based on weight of duct and hanger spacing
- Allow spacing equal to 1/4" of duct diameter between the Grippler fastener and duct (Dim. A)



- All hangers are available in 5', 10', 15', 20' and 30' standard lengths
- Lengths rounded up to nearest 5 ft increment
- Size of cable hanger (No.1 - No.5) will be based on weight of duct and hanger spacing
- Duct larger than 36" should be hung in 'cradle' fashion, with the hanger secured at two points to the roof / ceiling and the cable supporting the duct underneath

